

# Your HTC Desire 601

## Inserting your micro SIM and microSD cards

### **IMPORTANT: USE A STANDARD MICRO SIM ONLY.**

Inserting a smaller size SIM (such as nano SIM with an adapter or a modified SIM) may damage the card slot or cause the card to not fit properly.

1

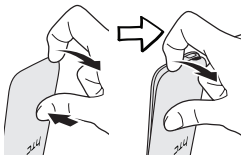
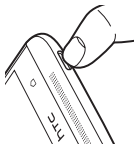

1. With one hand, securely hold your phone with the bottom edge facing up and the back facing you.

With your other hand, press your thumb on the back cover. From the notch (where the USB port is located), use your finger to open a small gap along the bottom edge. Then continue to lift open from the bottom edge. Slowly detach the cover from the phone to remove it.

2

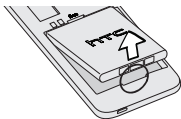

2. Make sure to remove the battery before inserting the micro SIM.

3

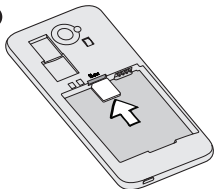

3. With your micro SIM card's gold contacts facing down and cut-off corner facing in, insert the micro SIM into the SIM slot and push it in until it clicks into place.

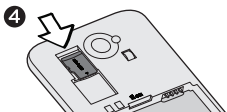

4. With your microSD card's gold contacts facing down, insert the microSD card into the storage card slot and push it in until it clicks into place.

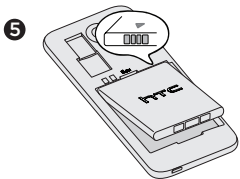

5. Reinsert the battery.

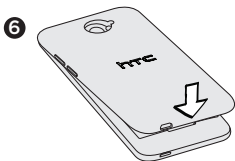

6. To replace the back cover, align the phone onto the top part of the back cover first. Then press the sides and the bottom part of the back cover down to lock the cover into place.

**Note:**

To avoid damaging the VOLUME buttons, don't press the buttons while replacing the back cover.

## Want some guidance on using your phone?

Check out our friendly walkthroughs in the **Tips & Help** app on your phone. Or go to [www.htc.com/support/](http://www.htc.com/support/) to find tutorials, the user guide, FAQs, latest news, and more.

© 2013 HTC Corporation. All rights reserved.

HTC, the HTC logo, and HTC Desire are trademarks of HTC Corporation. microSD is a trademark of SD-3C, LLC. All other company, product and service names mentioned herein are trademarks, registered trademarks or service marks of their respective owners.

